



**CASHREGISTER**  
WAREHOUSE

## Universal Payment Stand /PS-1010

All Steel

Adjustable Structure

Flexible Movement



### FEATURES

#### Universal for Various Payment Terminals

Every clip can be adjusted by loosening the screws under the plate.  
Easy to use: install your payment terminal and tighten the clips around it.  
Applicable to payment terminals of different sizes from 70-108.5mm wide.





## Steel Structure & Detail Design

Made of thick heavy-duty steel, the stand keep stable and durable even under frequent use. Many details have been added: detachable clips, flange cover, routing hole, etc. Customizable colors.



Please note that the PS-1010 has been tested with the EFTPOS terminals listed below, but should be suitable for use with any terminal that is 70mm-108.5mm in width, including terminals from Banks, Tyro, Smartpay and all other payment terminal providers.

ingenico iPP 350

ingenico iPP 320

ingenico iPP 315

ingenico iCT 250

ingenico iCT 220/220CL

ingenico iWL Series

ingenico iWE280

### Compatible payment terminals

ingenico APOS A8

ingenico Move/2500

ingenico Desk/5000

ingenico Desk/3000

ingenico Desk/1500

ingenico Lane/3000

Verifone T650c

Verifone V400c

Verifone V200c

Verifone P400

Verifone P200

Verifone VX820

Verifone VX805

Verifone VX680

PAX D210

PAX S300

PAX SP30



**CASHREGISTER**  
WAREHOUSE

## Flexible Movement

The upper pole can be rotated 180° from customer side to cashier side.  
Tilttable plate offers ideal viewing angle and adapts to different operation habits

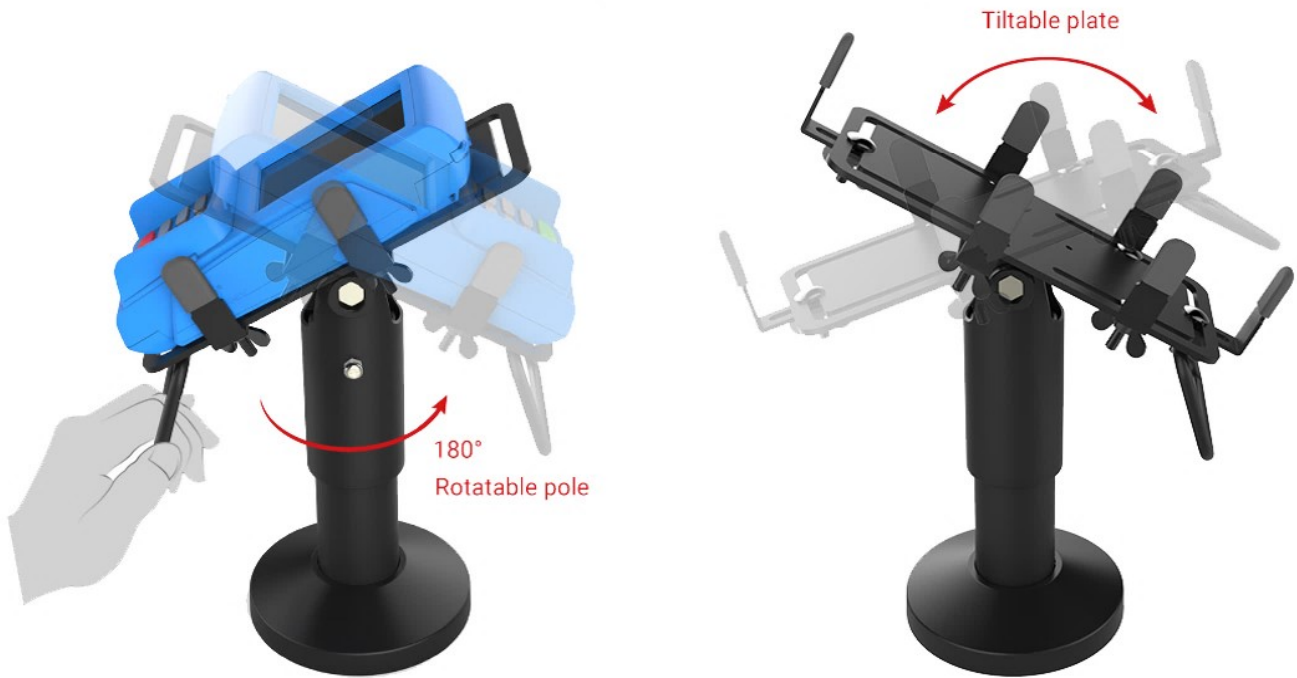

## Cost Saving

Customers can upgrade and replace their payment terminals at any time  
without worrying about additional installation costs.

